

# Easy LeadSheet Viewer

## Quick guide

Version: 0.9



(c) Thomas Koslowsky

Internet: [www.thomaskoslowsky.com](http://www.thomaskoslowsky.com)

Mail: [easyleadsheet@thomaskoslowsky.com](mailto:easyleadsheet@thomaskoslowsky.com)

Terms of use: <https://thomaskoslowsky.com/en/index.php/easy-leadsheet-viewer-terms-of-use/>

Data privacy: <https://thomaskoslowsky.com/en/index.php/easy-leadsheet-viewer-data-privacy/>

Application website: <https://thomaskoslowsky.com/en/index.php/easy-leadsheet-viewer/>

---

## Index

1 The main screen.....	3
2 The app options.....	6
3 Backup and restore data.....	7
4 Create a new Lead Sheet.....	8
5 Edit a chord-pro file.....	12
6 Visualize your Lead Sheet.....	13
7 Record and play audio of your performance.....	15
8 Troubleshooting & FAQ.....	16
8.1 Common problems.....	16
8.2 Frequently asked questions.....	16
9 Support.....	17
9.1 Contact information, feature requests and feedback.....	17

# 1 The main screen

The app contains two main views, the library on the left and the Lead Sheet view on the right.

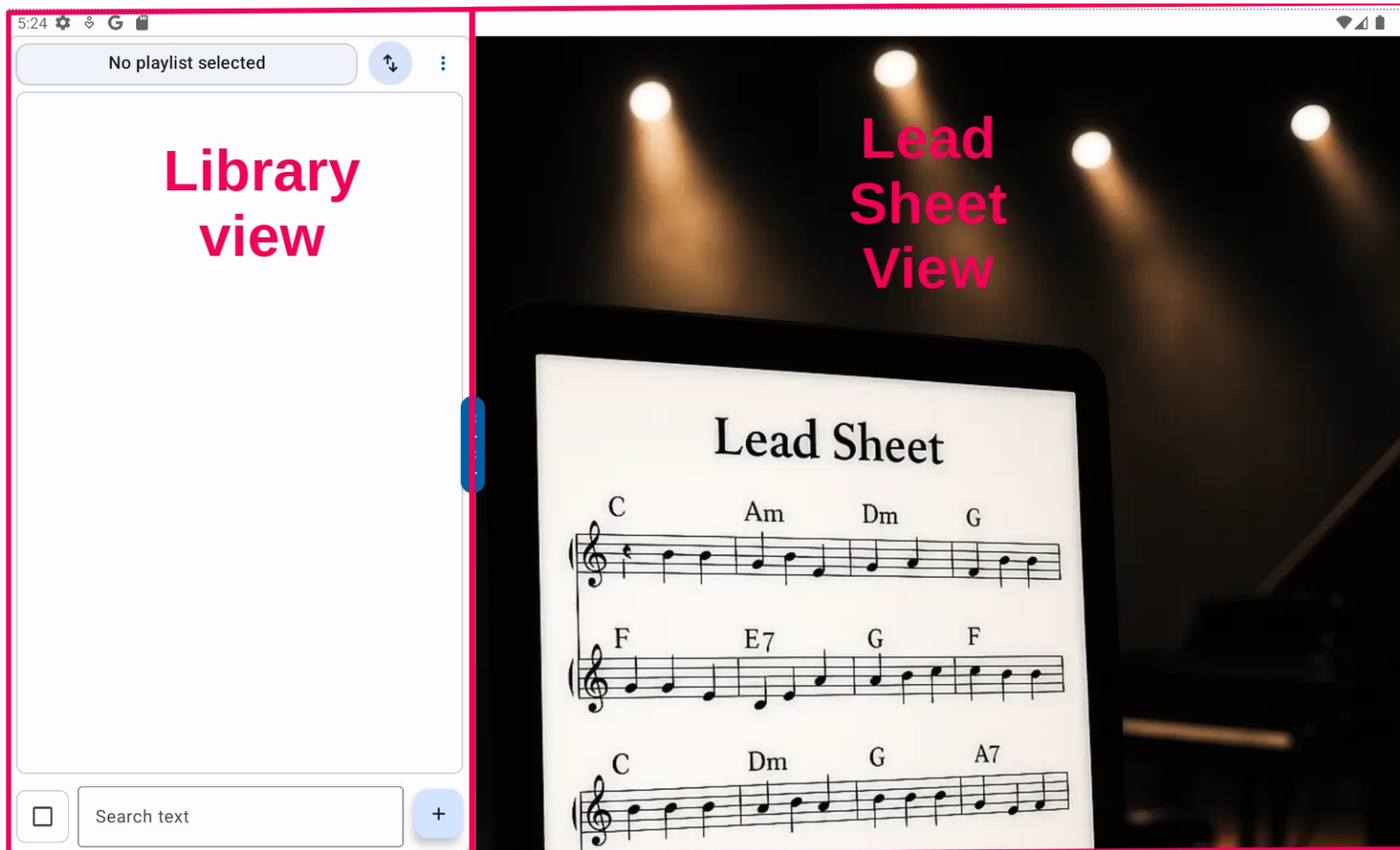

You can change the size by using the slider.

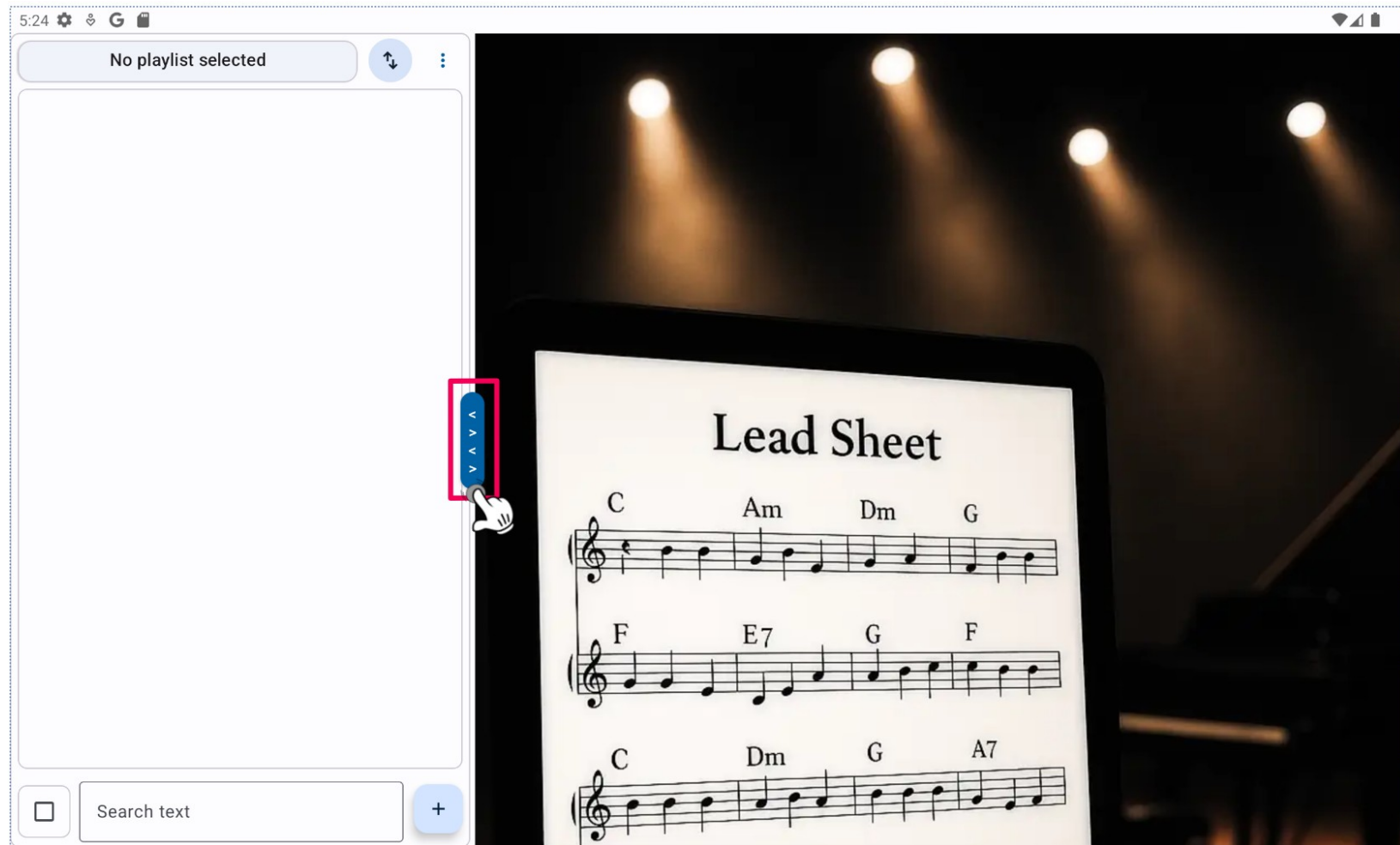

To access the main menu of the app use the slider to hide the library view.

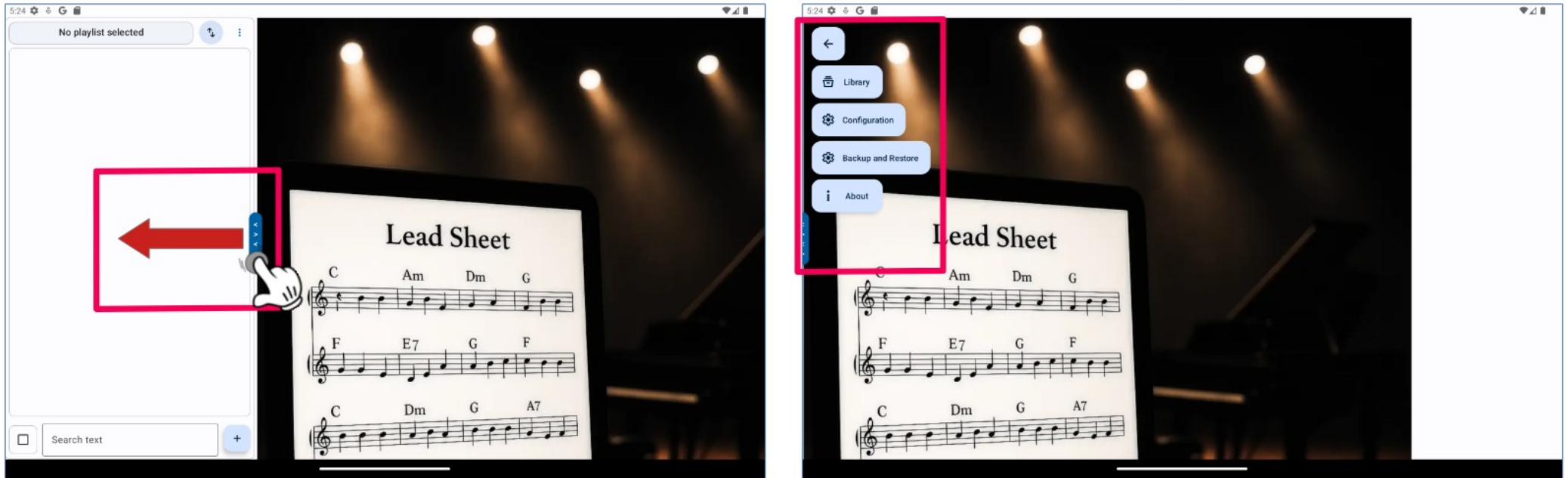

Through the main menu you get access to basic configuration settings and the data backup and synchronization.

## 2 The app options

In the app options you can adjust basic configurations.



### 3 Backup and restore data

You can backup to a local folder or a WebDAV server. The WebDAV option allows to synchronize your data between multiple devices.

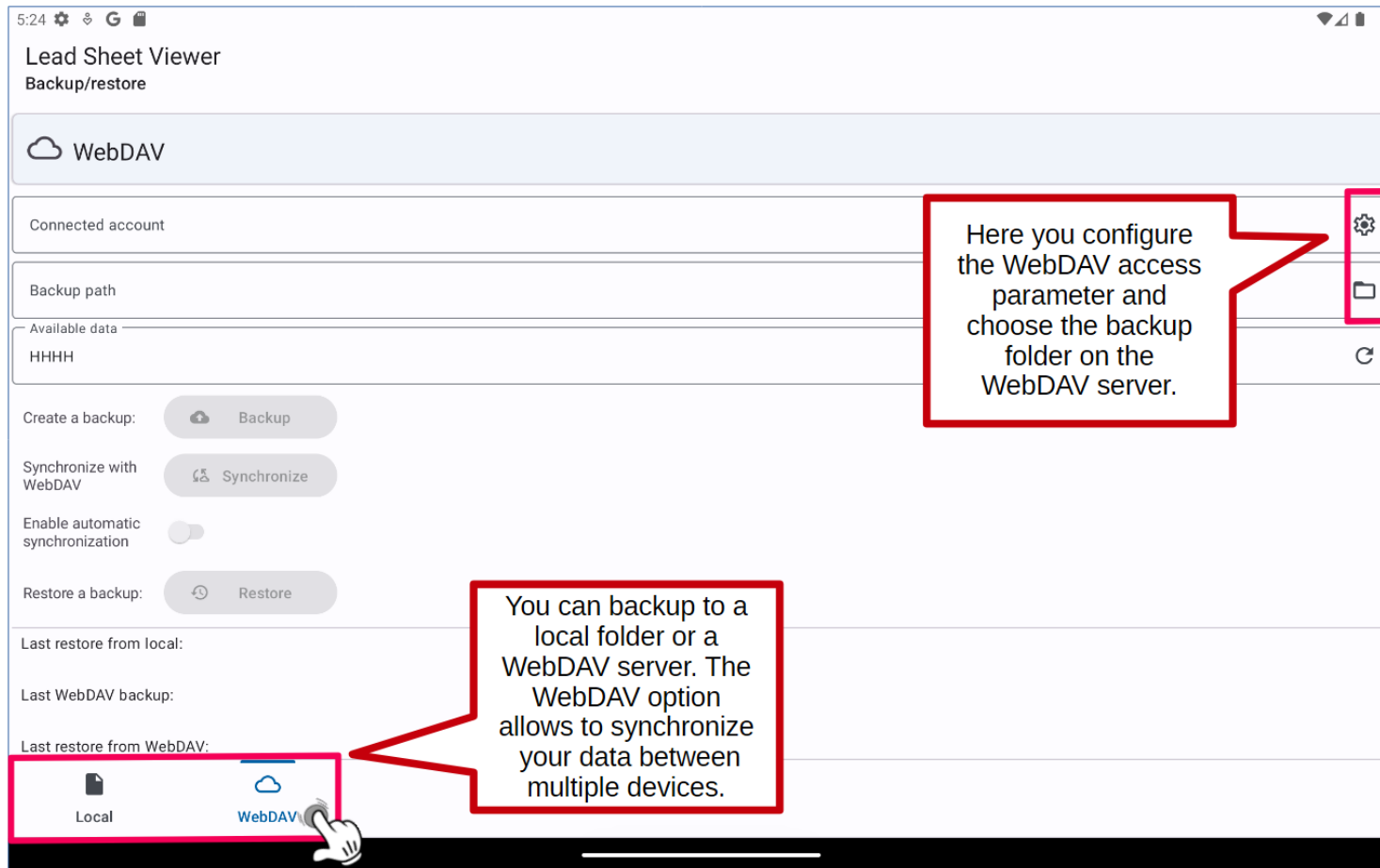

## 4 Create a new Lead Sheet

From the library view you can add a new Lead Sheet.

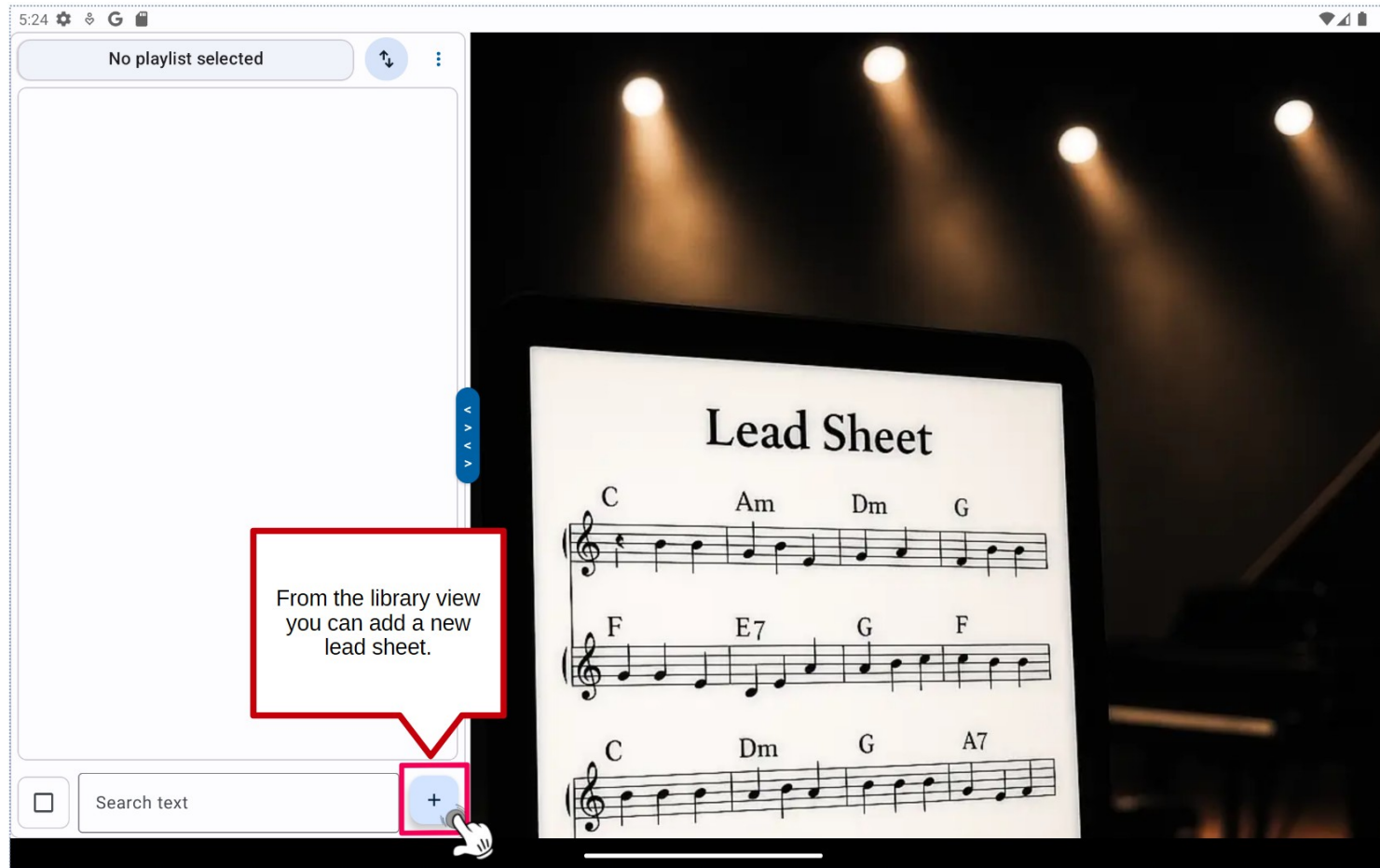

You can choose from different options for adding a new Lead Sheet. Image files, PDF files and text files (chord pro\*) are supported.

\*The chord pro format is currently limited to a very few commands to allow visualization of basic Lead Sheets.

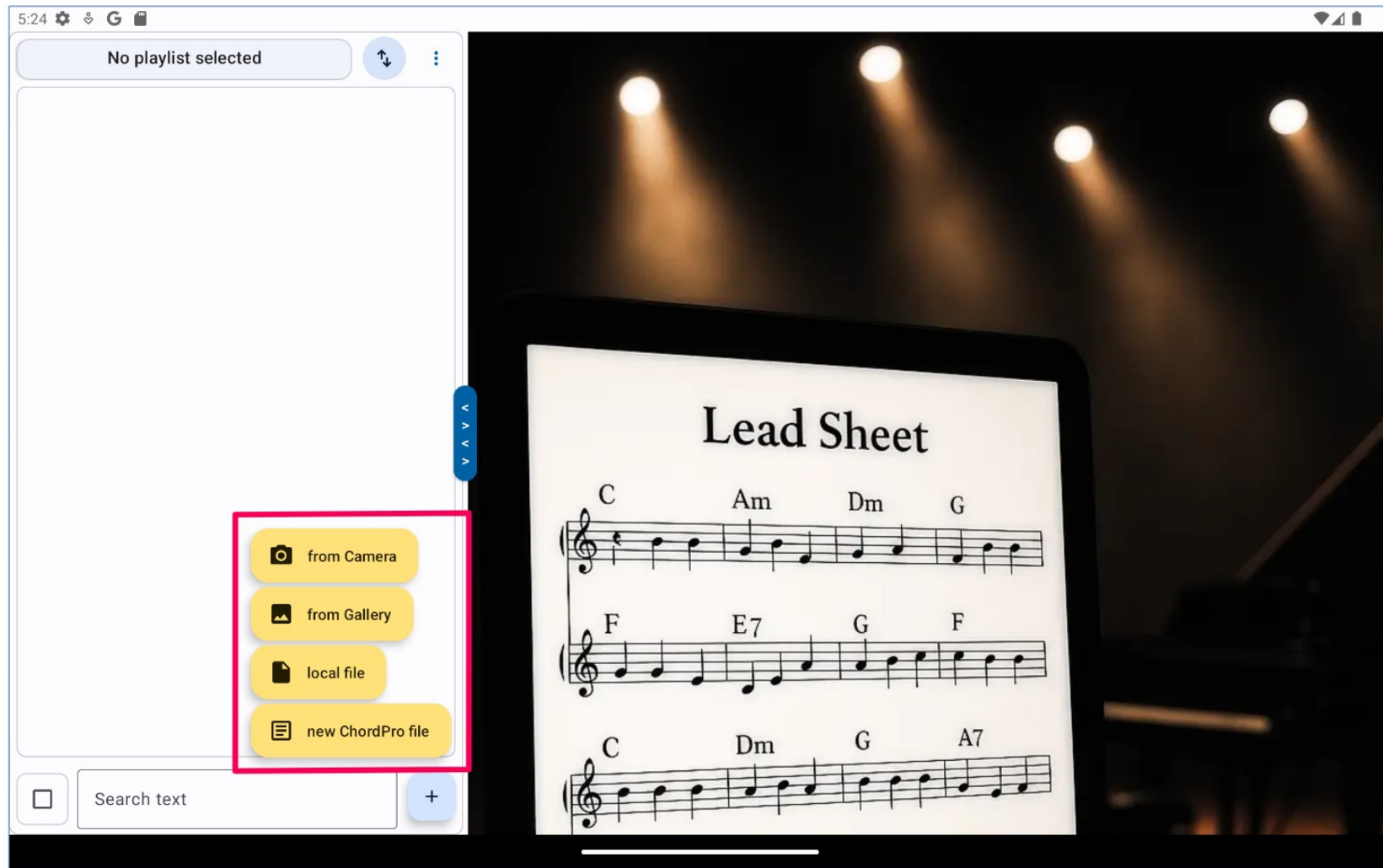

For each Lead Sheet you can store basic information. You can access and edit the data by sliding the library entry to the left or delete the entry by sliding it to the right.

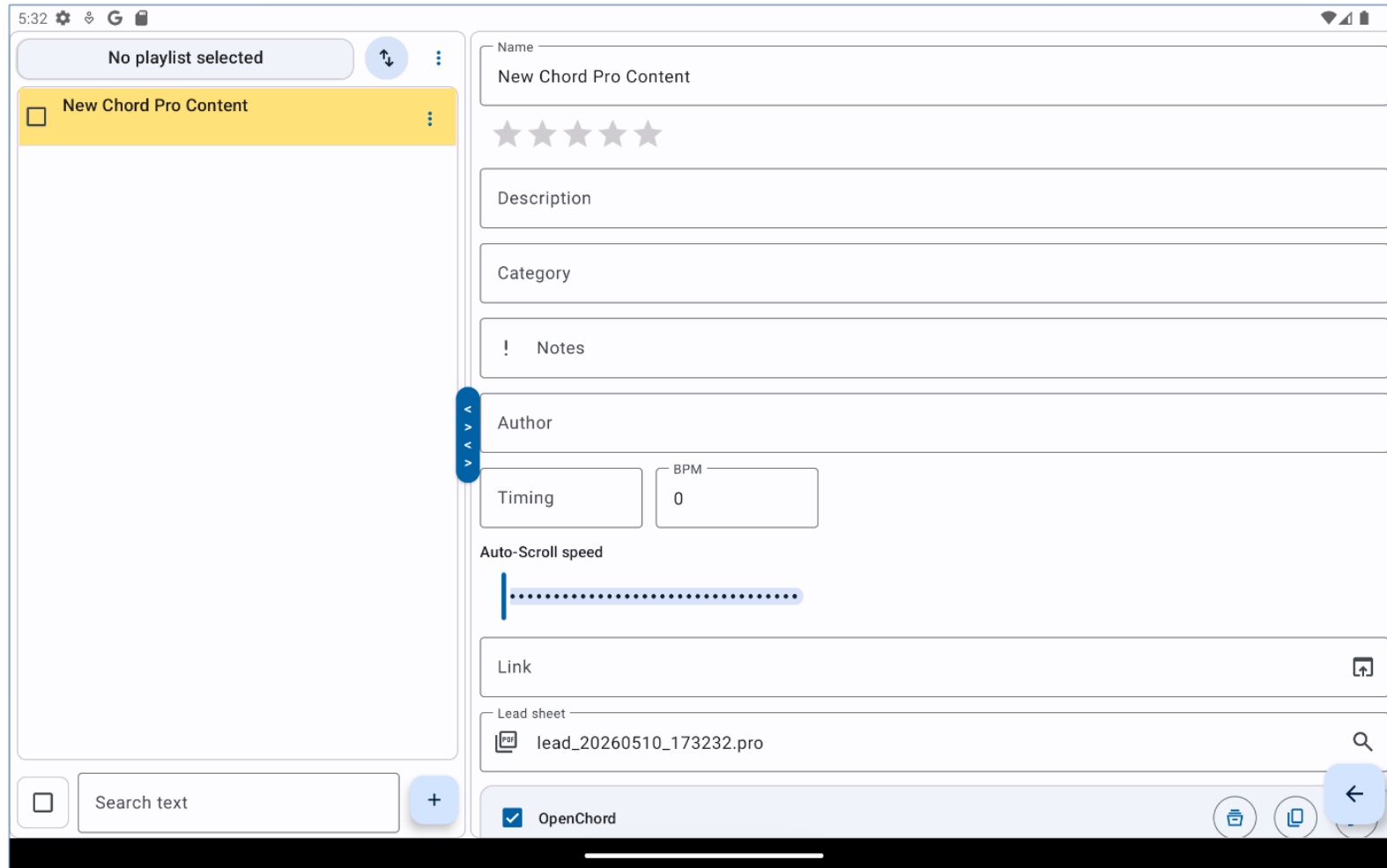

You can also store audio recordings and backing tracks, which can also be recorded and played from the main Lead Sheet view.

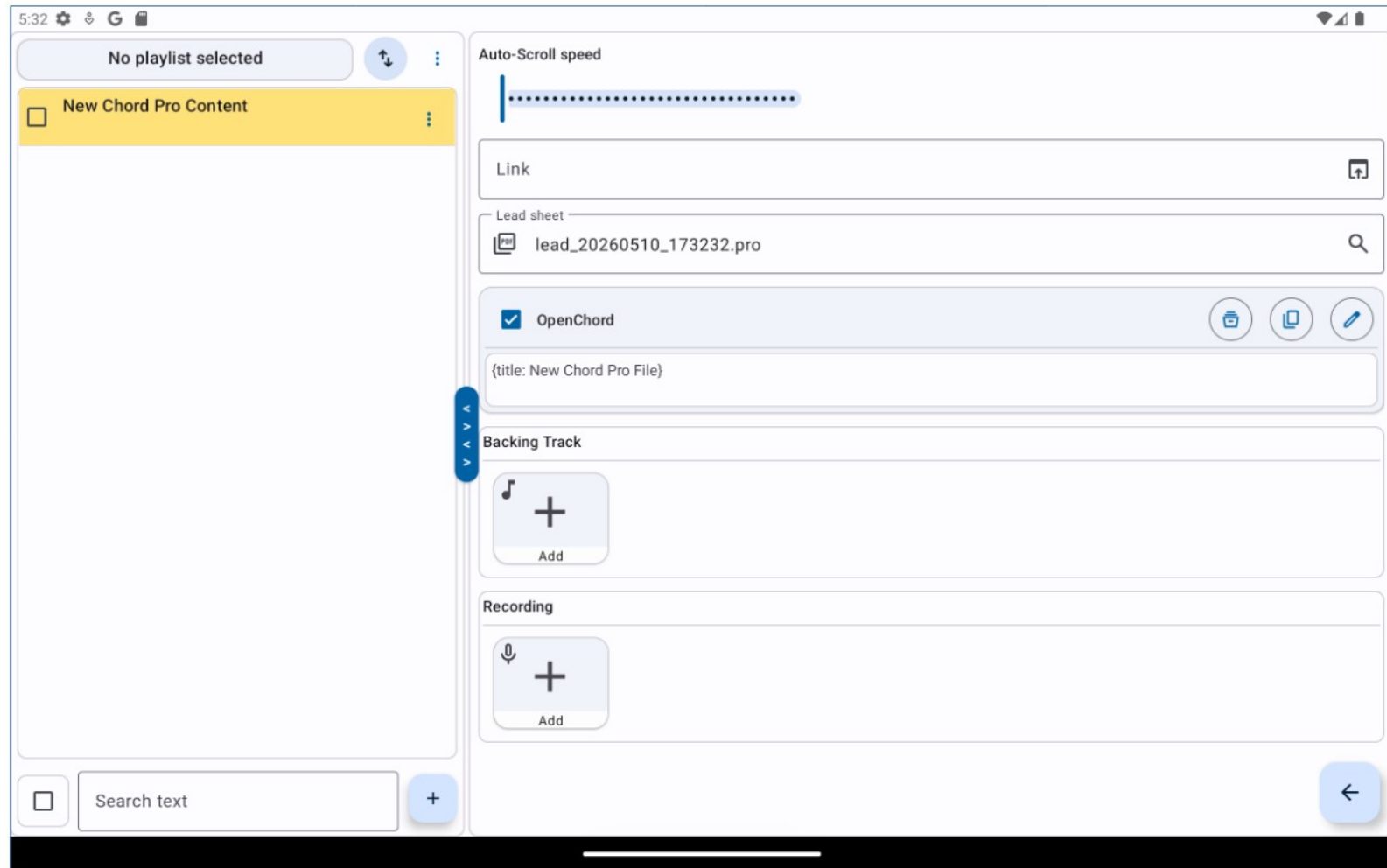

## 5 Edit a chord-pro file

The integrated chord pro editor is still experimental, allows basic editing and is limited to very few chord pro key words.

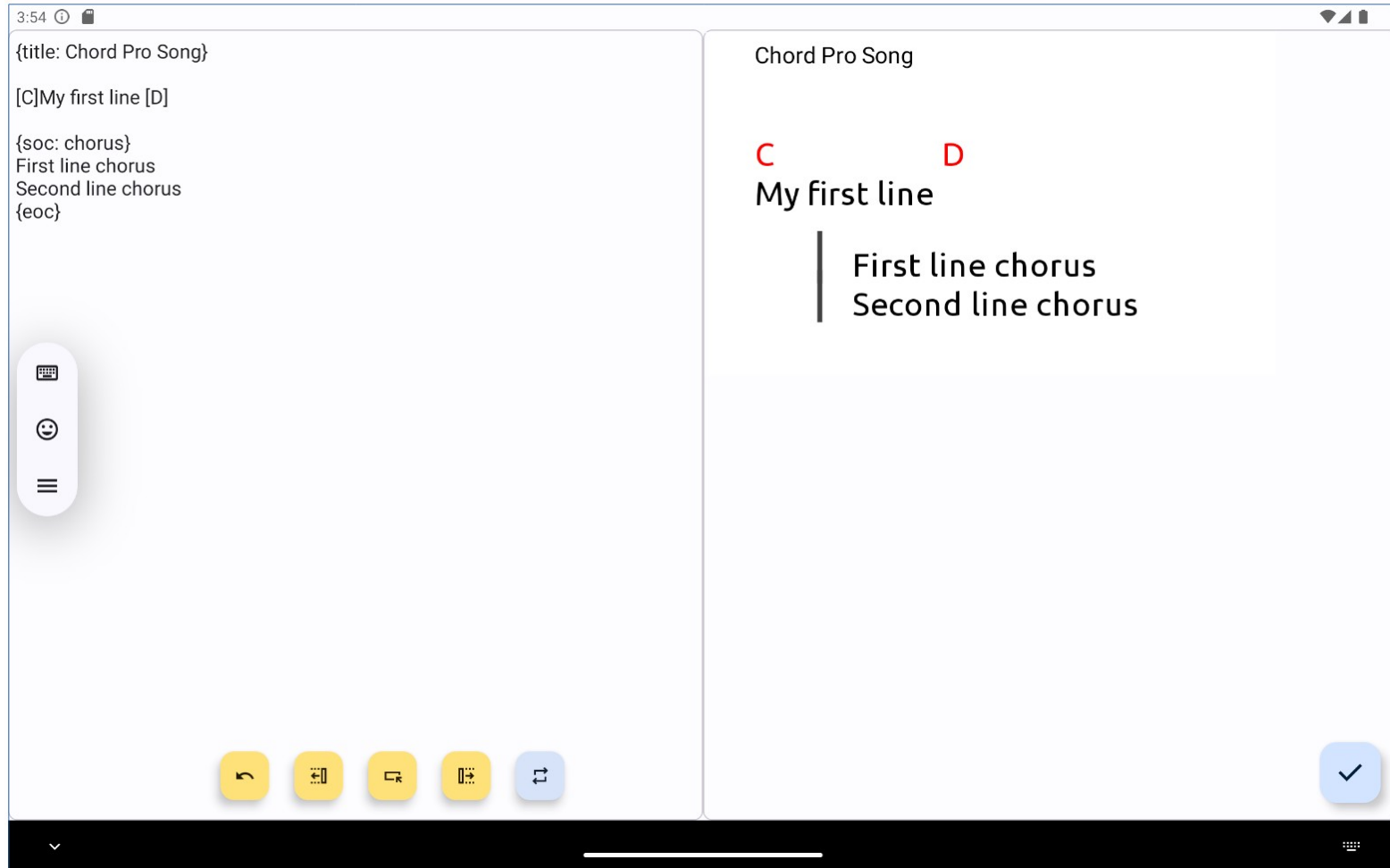

## 6 Visualize your Lead Sheet

From the library view you can select Lead Sheets to display, sort and filter your lead sheets. You can also manage playlists, which store basically your selection of Lead Sheets.

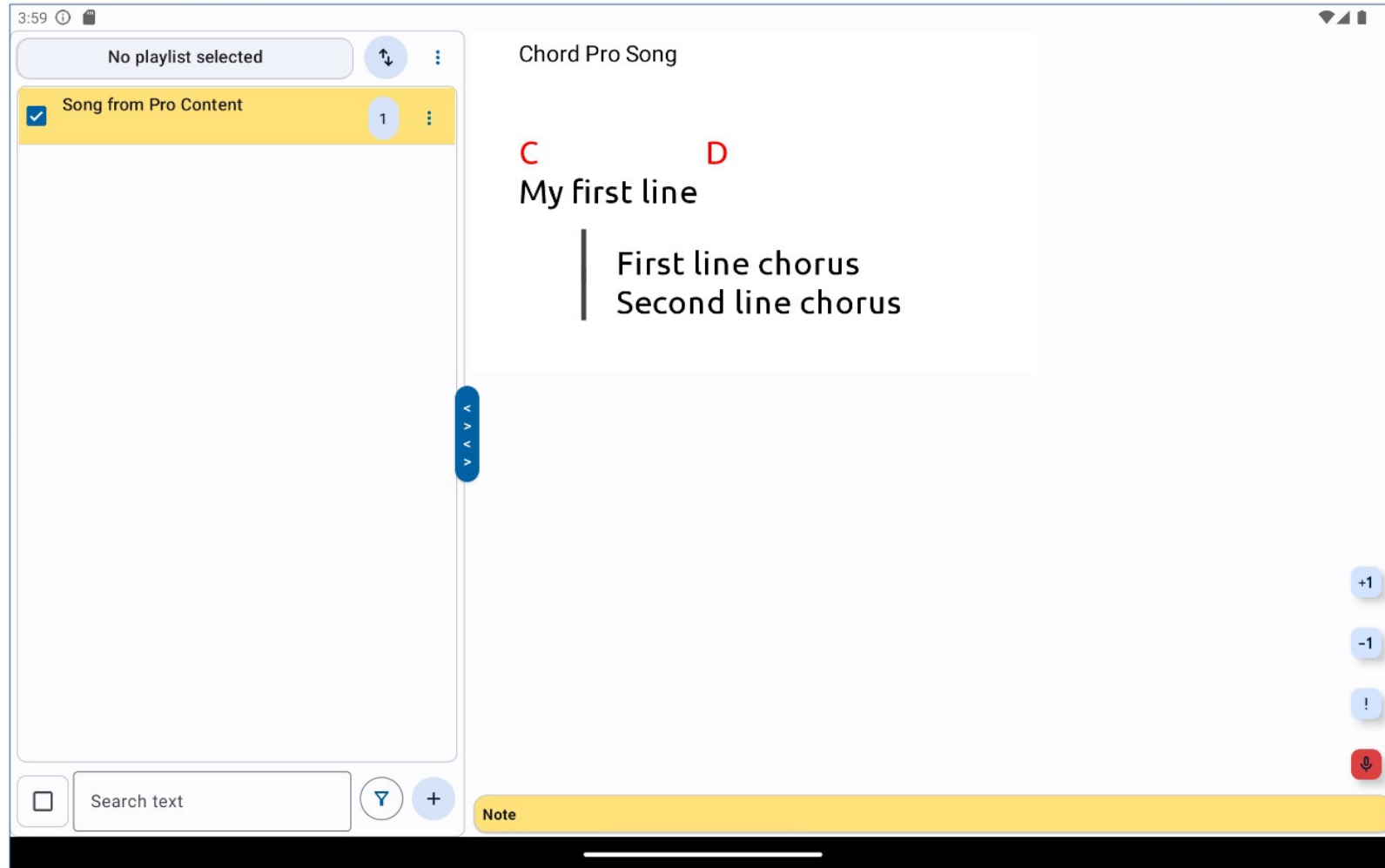

You can also move and zoom the Lead Sheet.

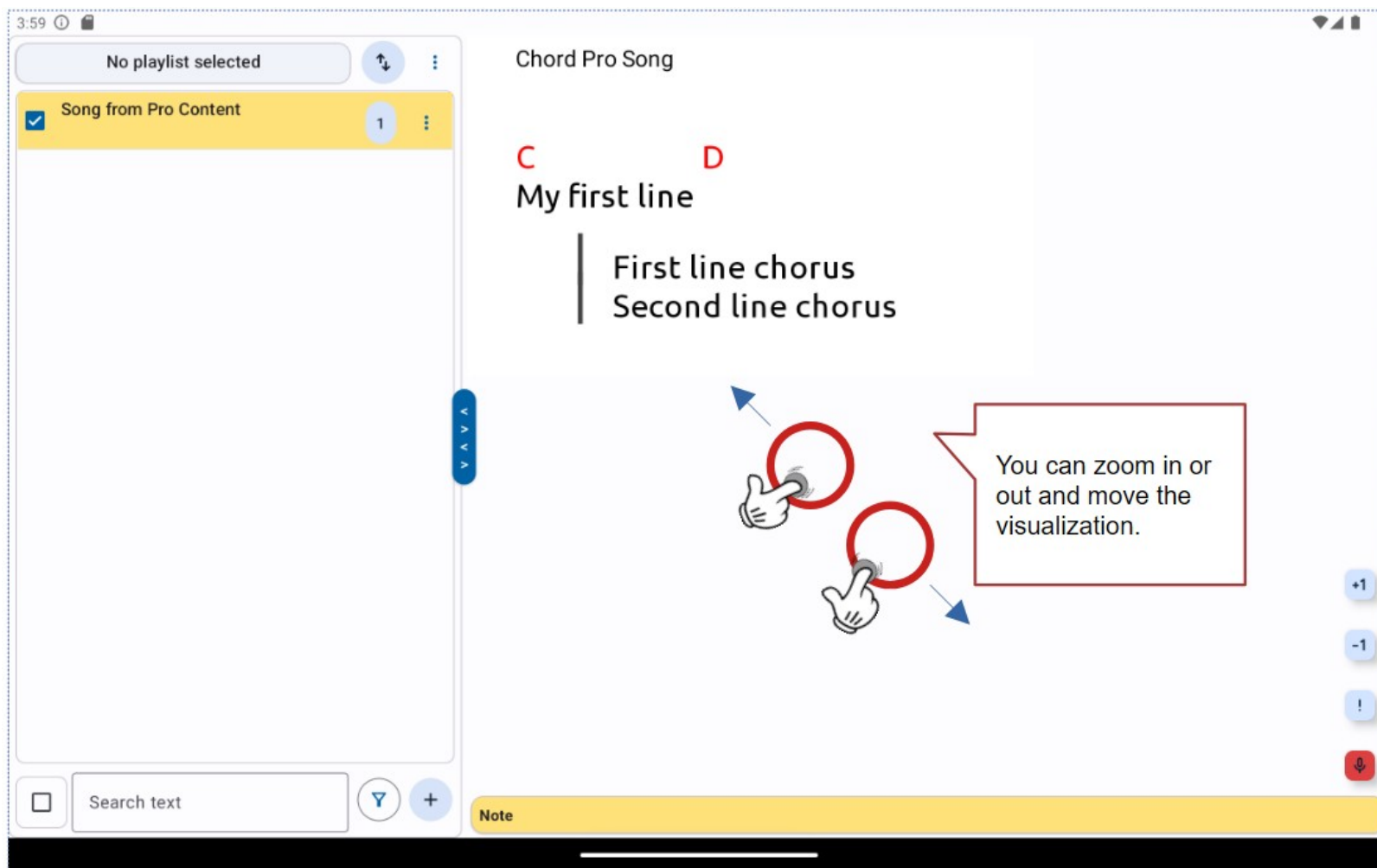

## 7 Record and play audio of your performance

In the Lead Sheet view you can record audio by clicking on the recording button. The action buttons become visible when you touch the Lead Sheet and hide automatically after a few seconds. Other action buttons allow access to the backing tracks, move forward and backward between selected Lead Sheets and transpose\* chord pro based Lead Sheets. The transpose feature is experimental and should be used with caution.

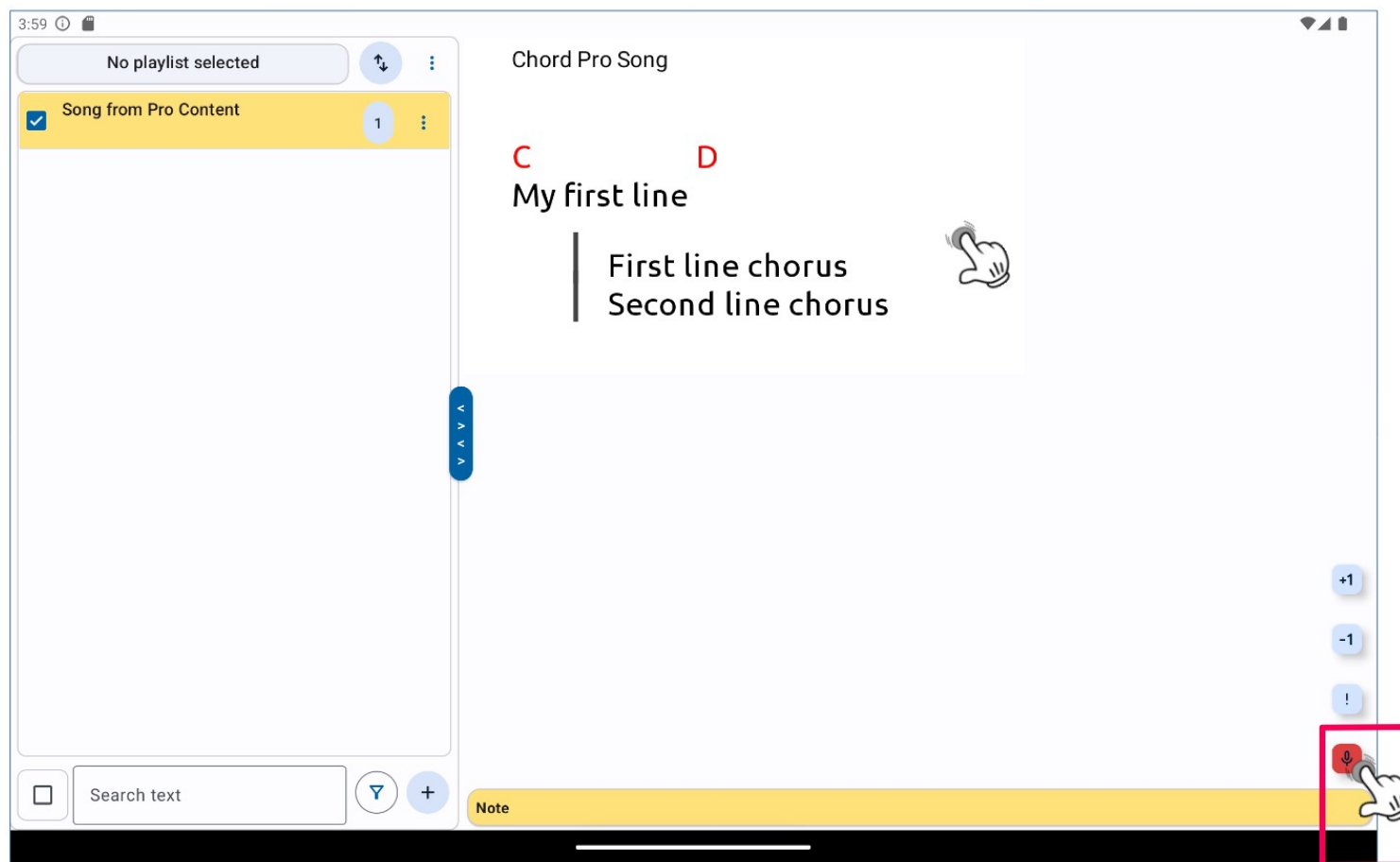

## 8 Troubleshooting & FAQ

### 8.1 Common problems

- An imported Lead-Sheet in chord-pro format is not shown completely  
→ the support of the chord-pro format is limited and will be extended in upcoming versions. You can contact us with your specific chord-pro format to analyze and probably prioritize specific keywords.

### 8.2 Frequently asked questions

- Is the available free of charge application limited in functionalities or features?  
→ no, all implemented features are available in the application. There is no other pro-version available.

## 9 Support

### 9.1 Contact information, feature requests and feedback

You can contact the developer with your feedback and feature request under:

[easyleadsheet@thomaskoslowsky.com](mailto:easyleadsheet@thomaskoslowsky.com)